

SPECIFICATIONS

Max. operating pressure:	See table
Rated flow:	See table
Weight:	1,13/2,5 kg (2,5/5,5 lbs)
Contamination class to ISO 4406:	See technical spec.
MTF _d :	150 years

NOTES

Regulation: FINE

OPTIONS

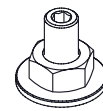

Screw and locknut



Handknob and locknut

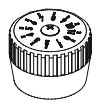

Graduated handknob

CURVES

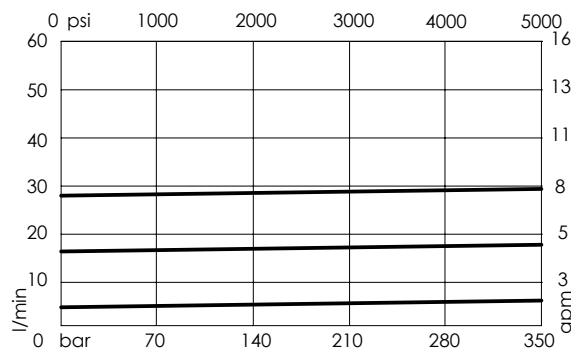

ORDERING CODES

Quick code	Description	Ports	Manifold	Max. pressure	Max. inlet flow	Max. regulated flow	Options
MF000008	MFCT-055-RVTR-30-G38-N210	E,R: G 3/8"	Aluminium	210 bar (3000 psi)	55 l/min (15 gpm)	30 l/min (8 gpm)	Handknob and locknut
MF000009	MFCT-055-RHTR-30-G38-N210	E,R: G 3/8"	Aluminium	210 bar (3000 psi)	55 l/min (15 gpm)	30 l/min (8 gpm)	Screw and locknut
MF000010	MFCT-055-RMTR-30-G38-N210	E,R: G 3/8"	Aluminium	210 bar (3000 psi)	55 l/min (15 gpm)	30 l/min (8 gpm)	Graduated handknob
MF000089	MFCT-055-RVSR-30-G38-N350	E,R: G 3/8"	Steel	350 bar (5000 psi)	55 l/min (15 gpm)	30 l/min (8 gpm)	Handknob and locknut
MF000090	MFCT-055-RHSR-30-G38-N350	E,R: G 3/8"	Steel	350 bar (5000 psi)	55 l/min (15 gpm)	30 l/min (8 gpm)	Screw and locknut
MF000091	MFCT-055-RMSR-30-G38-N350	E,R: G 3/8"	Steel	350 bar (5000 psi)	55 l/min (15 gpm)	30 l/min (8 gpm)	Graduated handknob