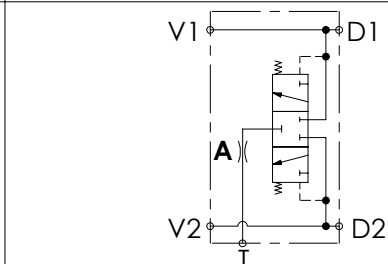
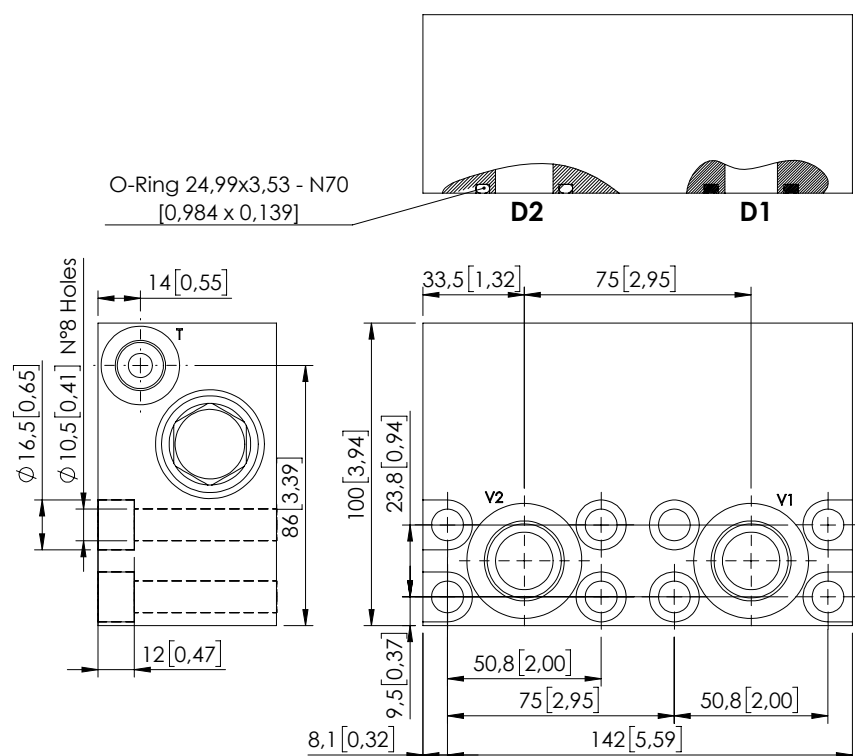

MFLN-300-RFSR

FLUSHING VALVE
FLANGEABLE TYPE

SPECIFICATIONS

| | |
|----------------------------------|---------------------|
| Max. operating pressure: | 420 bar (6000 psi) |
| Rated flow: | 200 l/min (53 gpm) |
| Manifold: | Steel |
| Weight: | 5,38 kg (11,86 lbs) |
| Contamination class to ISO 4406: | See technical spec. |
| MTTFa: | 150 years |

NOTES

For other configurations/quick codes not available in this catalogue page please consult factory

CURVES

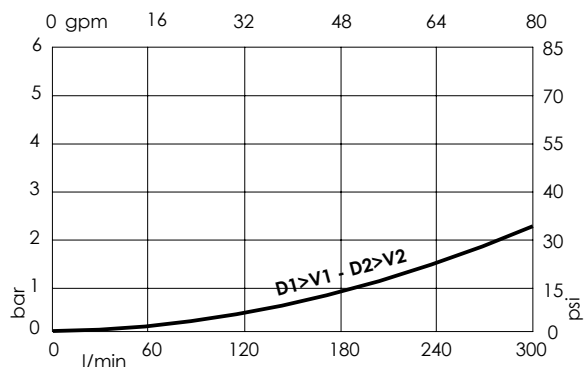
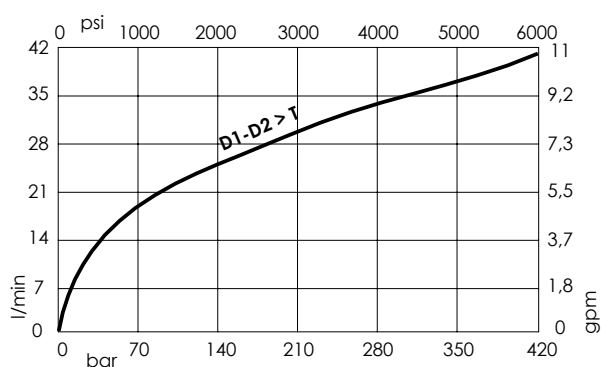

ORDERING CODES

| Quick code | Description | Main ports size | Spool setting | A orifice Ø | |
|------------|---------------------------|---|-------------------|----------------|--|
| MF000110 | MFLN-200-RFSR-09-S34-N420 | V1,V2:G3/4" D1,D2:3/4"SAE 6000 T: G3/8" | 6 bar (85 psi) | 1,9 [0,075] | |
| | | | | | |
| | | | | | |