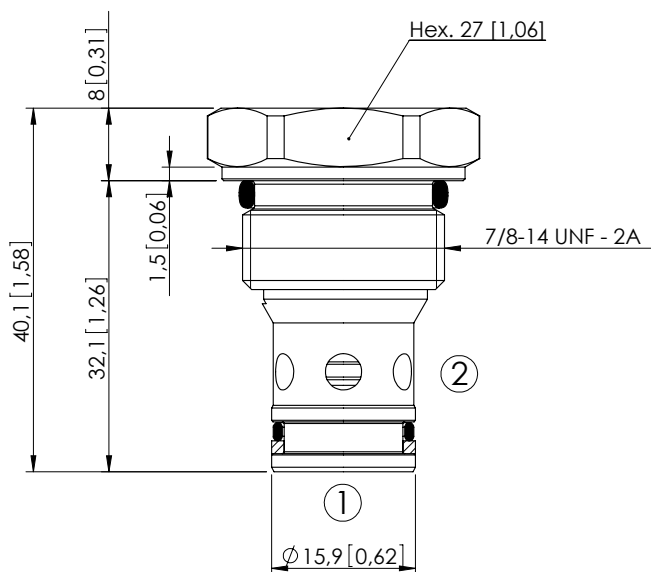

CHECK VALVE

CDVN-080-PSNR

POPPET TYPE

**SPECIFICATIONS**

Max. operating pressure:	350 bar (5000 psi)
Rated flow:	80 l/min (21 gpm)
Cavity:	SAE-10-2N
Weight:	0,09 kg (0,2 lbs)
Contamination class to ISO 4406:	See technical spec.
Seal kit:	RA700082
Installation torque:	55 - 62 Nm (41 - 46 ft-lb)
MTTF _d :	150 years

Dimensions: mm [inches]

NOTES

For other configurations/quick codes not available in this catalogue page please consult factory

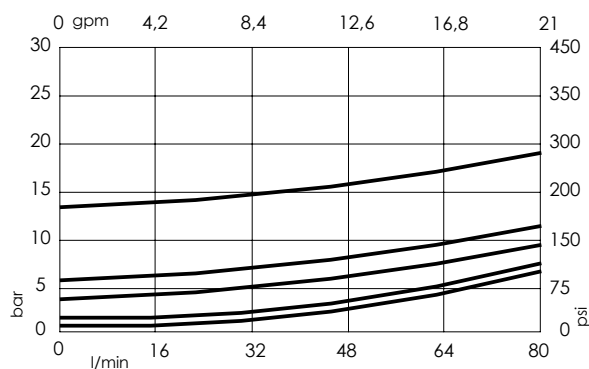
CURVES**ORDERING CODES**

Quick code	Description	Cracking pressure	
CD000100	CDVN-080-PSNR-FN-S10-N000	0,35 bar (5 psi)	
CD000023	CDVN-080-PSNR-FN-S10-N001	1 bar (15 psi)	
CD000169	CDVN-080-PSNR-FN-S10-N002	2 bar (30 psi)	
CD000101	CDVN-080-PSNR-FN-S10-N005	5,5 bar (75 psi)	
CD000092	CDVN-080-PSNR-FN-S10-N007	7 bar (100 psi)	
CD000082	CDVN-080-PSNR-FN-S10-N013	13 bar (200 psi)	