

CHECK VALVE

**CDVN-XXX-PSNC**

SLEEVE  
POPPET TYPE

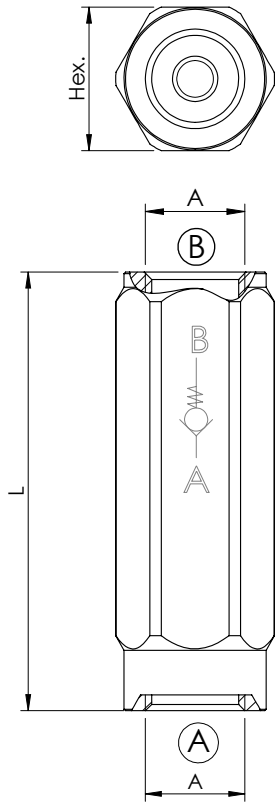

**SPECIFICATIONS**

Max. operating pressure:	350 bar (5000 psi)
Rated flow:	30 - 250 l/min (8 - 66 gpm)
Body:	Zinc plated steel
Weight:	0,1 - 1,59 kg (0,22 - 3,51 lbs)
Contamination class to ISO 4406:	See technical spec.
MTFa:	150 years

Dimensions: mm [inches]

**CURVES**

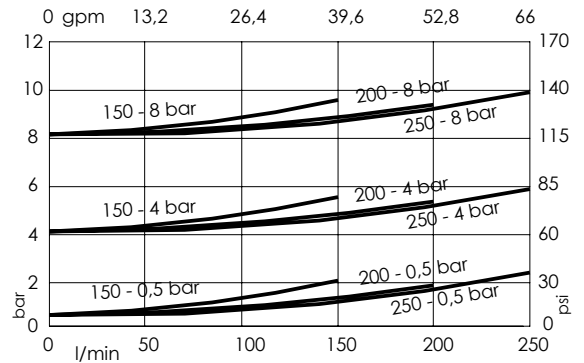
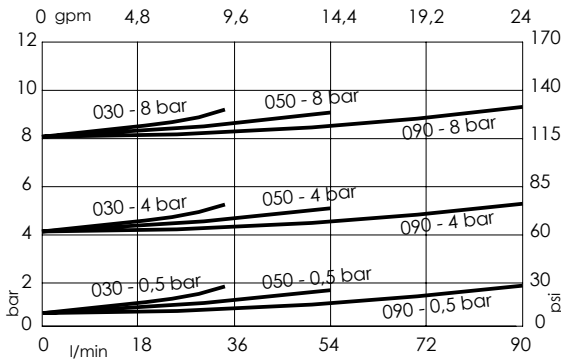

**ORDERING CODES**

Quick code	Description	Rated flow	Cracking pressure	Dimension		
				A	L	HEX
CD000324	CDVN-030-PSNC-FF-G14-N008	30 l/min (8 gpm)	8 bar (100 psi)	G 1/4"	58 [2,28]	19 [0,75]
CD000312	CDVN-030-PSNC-FF-G14-N004	30 l/min (8 gpm)	4 bar (50 psi)	G 1/4"	58 [2,28]	19 [0,75]
CD000317	CDVN-030-PSNC-FF-G14-N001	30 l/min (8 gpm)	0,5 bar (5 psi)	G 1/4"	58 [2,28]	19 [0,75]
CD000323	CDVN-050-PSNC-FF-G38-N008	50 l/min (13 gpm)	8 bar (100 psi)	G 3/8"	62 [2,44]	24 [0,95]
CD000318	CDVN-050-PSNC-FF-G38-N004	50 l/min (13 gpm)	4 bar (50 psi)	G 3/8"	62 [2,44]	24 [0,95]
CD000212	CDVN-050-PSNC-FF-G38-N001	50 l/min (13 gpm)	0,5 bar (5 psi)	G 3/8"	62 [2,44]	24 [0,95]
CD000277	CDVN-090-PSNC-FF-G12-N008	90 l/min (24 gpm)	8 bar (100 psi)	G 1/2"	71 [2,8]	30 [1,18]
CD000287	CDVN-090-PSNC-FF-G12-N004	90 l/min (24 gpm)	4 bar (50 psi)	G 1/2"	71 [2,8]	30 [1,18]
CD000281	CDVN-090-PSNC-FF-G12-N001	90 l/min (24 gpm)	0,5 bar (5 psi)	G 1/2"	71 [2,8]	30 [1,18]
CD000278	CDVN-150-PSNC-FF-G34-N008	150 l/min (40 gpm)	8 bar (100 psi)	G 3/4"	83 [3,27]	36 [1,42]
CD000421	CDVN-150-PSNC-FF-G34-N006	150 l/min (40 gpm)	6 bar (75 psi)	G 3/4"	83 [3,27]	36 [1,42]
CD000288	CDVN-150-PSNC-FF-G34-N004	150 l/min (40 gpm)	4 bar (50 psi)	G 3/4"	83 [3,27]	36 [1,42]
CD000282	CDVN-150-PSNC-FF-G34-N001	150 l/min (40 gpm)	0,5 bar (5 psi)	G 3/4"	83 [3,27]	36 [1,42]
CD000279	CDVN-200-PSNC-FF-G10-N008	200 l/min (53 gpm)	8 bar (100 psi)	G 1"	106 [4,17]	45 [1,77]
CD000289	CDVN-200-PSNC-FF-G10-N004	200 l/min (53 gpm)	4 bar (50 psi)	G 1"	106 [4,17]	45 [1,77]
CD000283	CDVN-200-PSNC-FF-G10-N001	200 l/min (53 gpm)	0,5 bar (5 psi)	G 1"	106 [4,17]	45 [1,77]
CD000280	CDVN-250-PSNC-FF-G11-N008	250 l/min (66 gpm)	8 bar (100 psi)	G 1" 1/4	127 [5]	55 [2,17]
CD000290	CDVN-250-PSNC-FF-G11-N004	250 l/min (66 gpm)	4 bar (50 psi)	G 1" 1/4	127 [5]	55 [2,17]
CD000284	CDVN-250-PSNC-FF-G11-N001	250 l/min (66 gpm)	0,5 bar (5 psi)	G 1" 1/4	127 [5]	55 [2,17]