

SPECIFICATIONS

Max. operating pressure:	See table
Rated flow:	See table
Weight:	1,11/2,5 kg (2,5/5,5 lbs)
Contamination class to ISO 4406:	See technical spec.
MTF _d :	150 years

NOTES

Regulation: FINE

OPTIONS

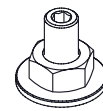

Screw and locknut



Handknob and locknut

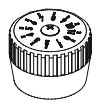

Graduated handknob

CURVES

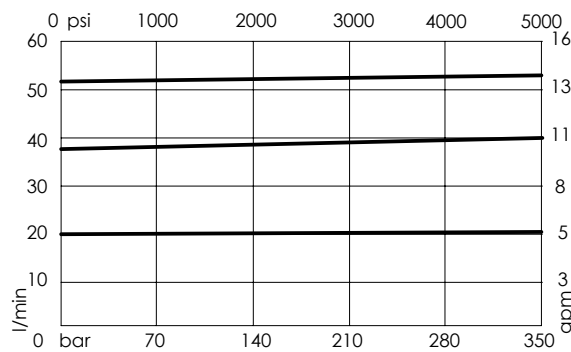

ORDERING CODES

Quick code	Description	Ports	Manifold	Max. pressure	Max. inlet flow	Max. regulated flow	Options
MF000015	MFCT-090-RVTR-55-G12-N210	E,R: G 1/2"	Aluminium	210 bar (3000 psi)	90 l/min (24 gpm)	55 l/min (15 gpm)	Handknob and locknut
MF000016	MFCT-090-RHTR-55-G12-N210	E,R: G 1/2"	Aluminium	210 bar (3000 psi)	90 l/min (24 gpm)	55 l/min (15 gpm)	Screw and locknut
MF000014	MFCT-090-RMTR-55-G12-N210	E,R: G 1/2"	Aluminium	210 bar (3000 psi)	90 l/min (24 gpm)	55 l/min (15 gpm)	Graduated handknob
MF000095	MFCT-090-RVSR-55-G12-N350	E,R: G 1/2"	Steel	350 bar (5000 psi)	90 l/min (24 gpm)	55 l/min (15 gpm)	Handknob and locknut
MF000096	MFCT-090-RHSR-55-G12-N350	E,R: G 1/2"	Steel	350 bar (5000 psi)	90 l/min (24 gpm)	55 l/min (15 gpm)	Screw and locknut
MF000097	MFCT-090-RMSR-55-G12-N350	E,R: G 1/2"	Steel	350 bar (5000 psi)	90 l/min (24 gpm)	55 l/min (15 gpm)	Graduated handknob